

MONTAGE

1

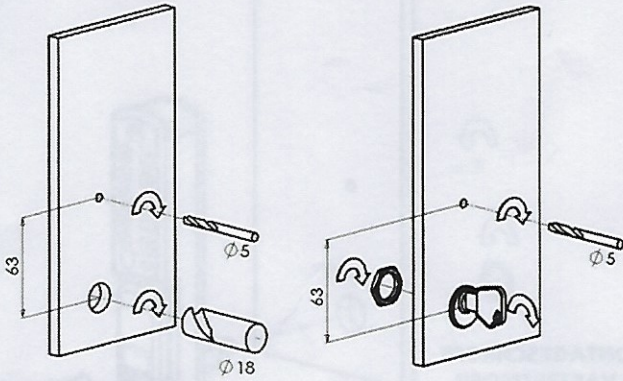

NIEUWE SITUATIE

OMBOUW BESTAANDE SITUATIE

2

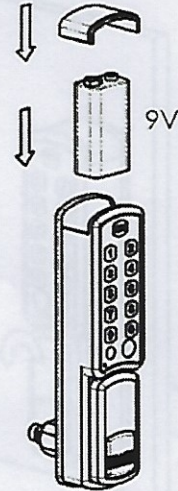

3

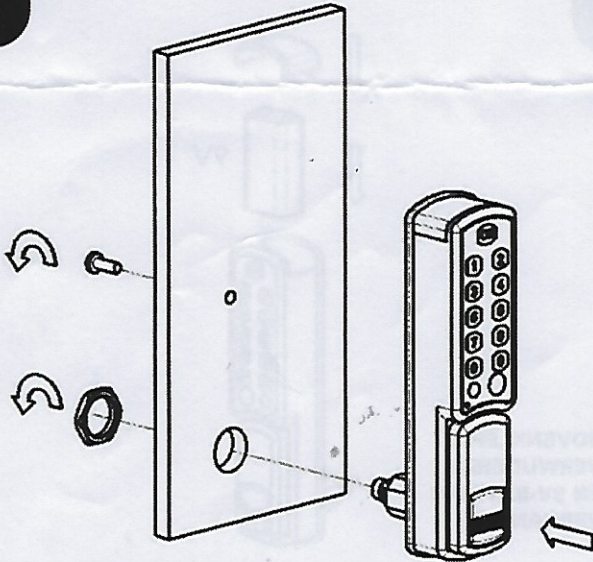

**MONTAGESCHROEF EN VASTZETMOER
VASTDRAAIEN (HANDVAST)**

4

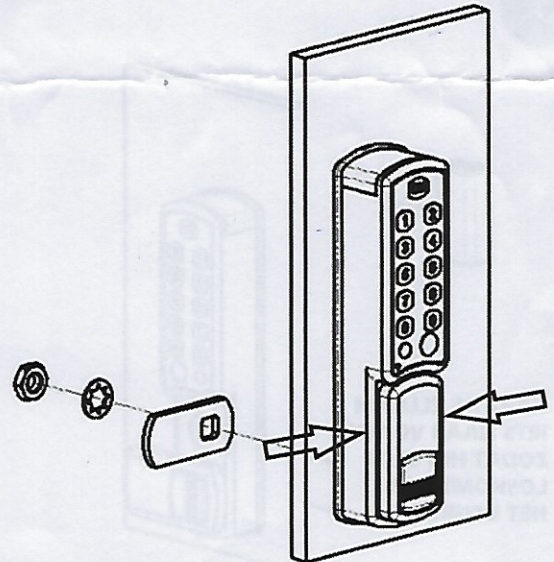

**HOUD GREEP VAST
BIJ HET MONTEREN VAN DE SLUITLIP**

5

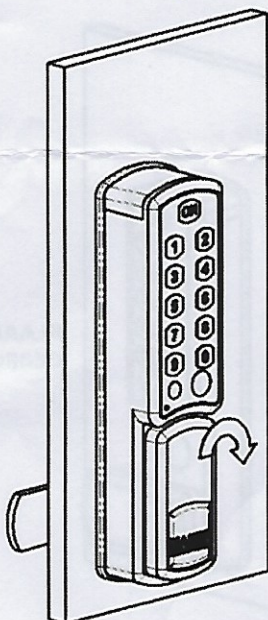

OPEN

**CODE
X-X-X-X**

**(UW CODE
OF FABRIEKSCODE
1-2-3-4)**

6

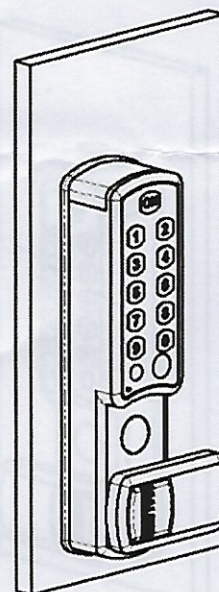

**KLAAR VOOR
GEBRUIK**

1

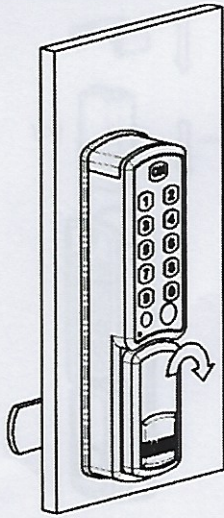

OPEN

CODE
X-X-X-X

(UW CODE OF
FABRIEKSCODE
Z.O.Z.)

2

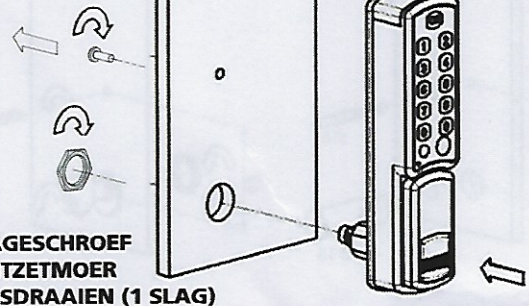

MONTAGESCHROEF
EN VASTZETMOER
IETS LOSDRAAIEN (1 SLAG)

3



9V

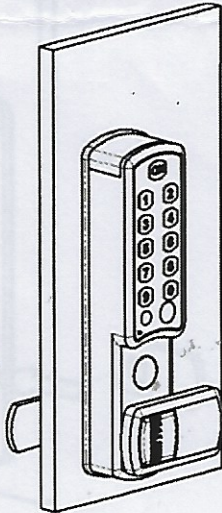

HAAL DE ELLCAM
IETS NAAR VOREN
ZODAT HET SLOT
LOSKOMT VAN
HET DEURTJE

4

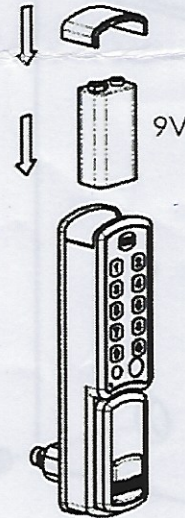

BOVENKLEPJE
VERWIJDEREN
EN 9V-BATTERIJ
VERVANGEN

5

MONTAGEMOER EN
VASTZETMOER
WEER VASTDRAAIEN
(HANDVAST)

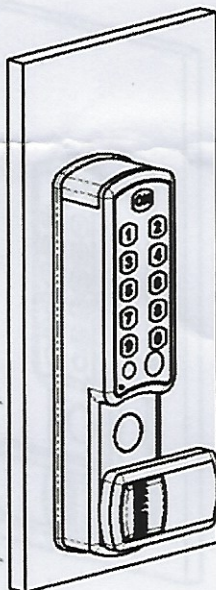
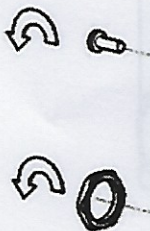

6

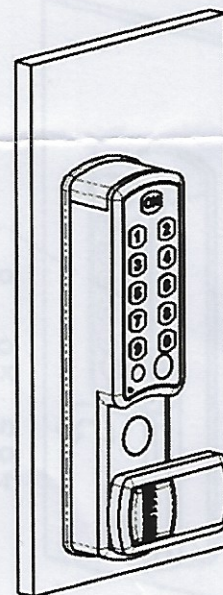

KLAAR VOOR
GEBRUIK